



Manufacturer of
Industrial Robotic arm
SPM & Factory Automation



Let's Make **India** Self **Sufficient**
in **Robotics & Automation**

www.ashtatech.com

ASHTATECH is a **Central India's largest** Smart Factory Automation & SPM Machine Manufacturer. We started our journey with an aim of making world-class machines especially with critical applications. As the name ASHTA which means 8 in Sanskrit, We serve 8 domains ranging from Textile & Mattresses Food Processing, Electronics, Automobile, Pharmaceutical, Aeronautics and Aerospace. Our passionate team of eminent engineers use the latest & futuristic trends in our machines delivering a way beyond technology making our fleet of machines smarter everyday. We believe in Innovation with simplicity and affordable excellence. Since a decade we are solving the customers problem with our smart machines. We understand customers pain points and strive to make solutions for them.

We stand by the values of an great Indian Scientist: Dr. Rangunath Mashelkar Sir as he truly says "More from less for more"

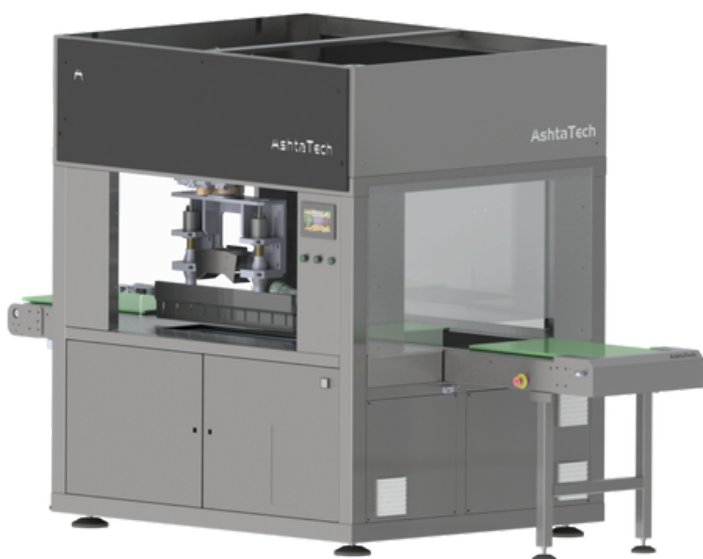

Ultrasonic Kaju Katli Cutting Machine

The ultrasonic Kaju Katli cutting machine is a specialized device used in the confectionery industry to cut Kaju Katli sweets with precision and efficiency. It uses ultrasonic vibrations to achieve clean and uniform cuts without damaging the texture or appearance of the sweet. This non-contact cutting method ensures consistent results and is ideal for high-volume production.

Twin Station Automatic Soanpapdi Cutting Machine

A twin station Soan Papadi cutting machine is a specialized device designed to cut Soan Papadi with efficiency and precision. This machine features two cutting stations, allowing for simultaneous cutting of multiple pieces. It is specifically tailored to handle the delicate and flaky texture of Soan Papadi, ensuring neat and uniform cuts without compromising its quality. The machine is widely used in commercial food production facilities, streamlining the manufacturing process and improving productivity.



ASH-UV 500 Sterilization Conveyor

Introducing the ASHUV500 Sterilization Conveyor by AshtaTech. This fully automated conveyor system utilizes advanced UV-C sterilization technology to ensure effective sterilization of trays and boxes which is very useful to **increase the shelf life** of end products like sweets. With its high-speed operation, precise conveyor configuration, and superior sterilization capabilities, it is an ideal solution for various industries.

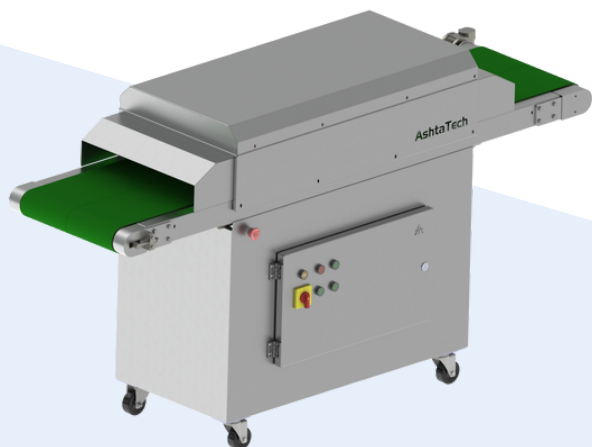

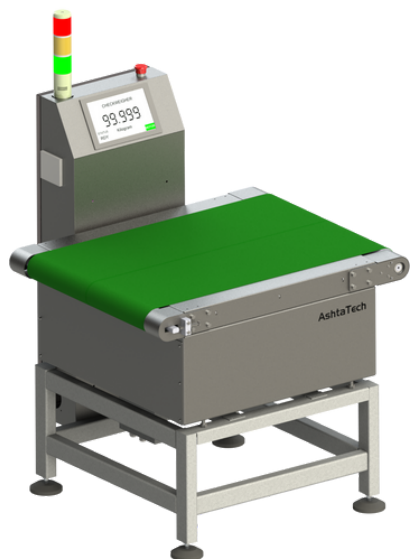

Online Checkweigher Machine

An online checkweigher is an automated device used in industries like food, pharmaceuticals, and manufacturing to ensure accurate weight measurements of products during production or packaging. It quickly checks the weight of items on a conveyor system, identifying any deviations from the target weight. This helps maintain quality control, comply with regulations, and minimize giveaway, improving efficiency and product quality.



Variable Volumetric Dispenser With Precision

Introducing Ashtatech's Variable Volumetric Dispensing Machine, a precision solution for the food industry. This advanced machine offers fast and accurate dispensing of liquids like sugar syrup, milk, curd, buttermilk, etc... Equipped with a unique mechanism and user-friendly PLC & HMI, it enables easy selection and precise control of dispensing quantities. Enhance efficiency, reduce waste, and ensure product consistency with Ashtatech's cutting-edge technology.



Transfer Pump

The Transfer Pump is a versatile and efficient automated solution designed for fluid transfer in various industries. With its high-performance capabilities and durable construction, it ensures reliable and precise fluid handling, contributing to improved production processes and operational efficiency.



Automatic **Sugar Dispensing** System

An online sugar dispensing system is an automated device used in industries to accurately dispense sugar. It eliminates manual measuring, When a sugar portion is required, the dispensing mechanism releases the predetermined amount of sugar, ensuring accuracy and reducing waste.

This process can be integrated into existing production lines or used as a standalone system, ensuring precise portions and improving efficiency. It saves time, enhances accuracy, and promotes cleanliness in production processes.

Industrial **Pan Chiller**

The Industrial Pan Chiller by AshtaTech is a high-performance cooling system designed for various industries, including food manufacturing, mattress production, and automobile manufacturing. It offers efficient cooling for large pans, trays, or molds used in production processes, ensuring optimal temperature control and preserving product quality.

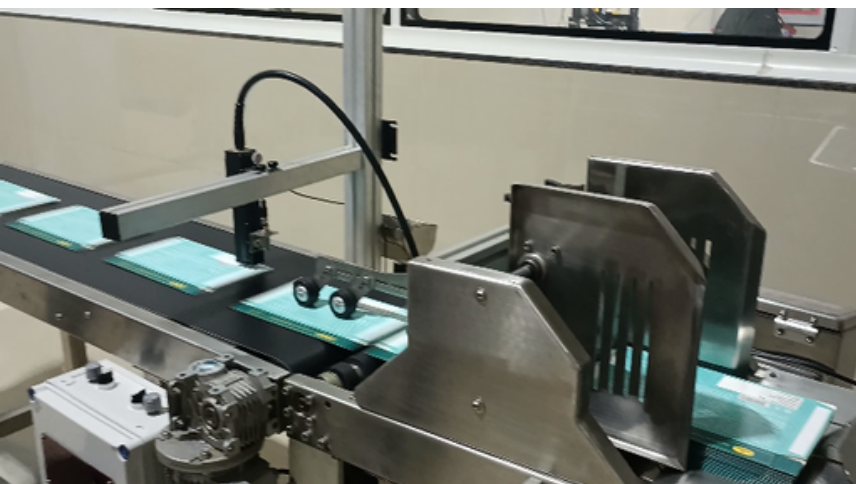

Print & Pack Conveyrise Line

The Printing & Packing Conveyrise Line by AshtaTech is a comprehensive automated solution designed for industries such as food manufacturing, and automobile manufacturing. It integrates printing and packing processes into a seamless conveyor system, offering efficient and streamlined production with enhanced productivity and quality control.

Mattress Industry

Ashtatech, a pioneering Indian company, has successfully developed an indigenous alternative for the mattress industry in India. Previously, the mattress manufacturing machinery was predominantly imported from countries such as Turkey and other European nations. Ashtatech stands apart as the sole company in Pan India specializing in the manufacturing of cutting-edge smart mattress manufacturing machines within the country. This achievement highlights Ashtatech's commitment to technological excellence and its significant contribution to promoting self-sufficiency in the Indian mattress manufacturing sector, reducing dependence on foreign imports.

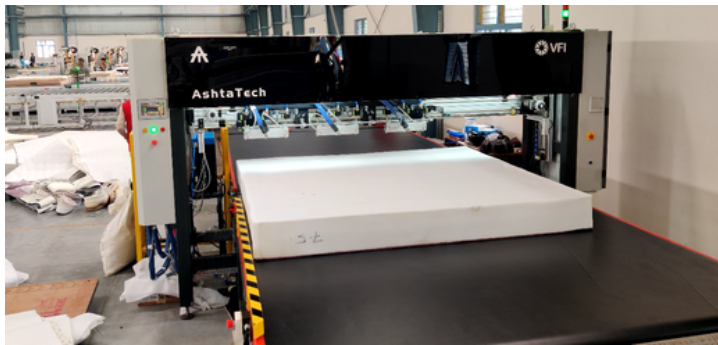

Automatic Hot Melt Glue Line for Mattress Manufacturing

ASHUGLUE-2020 is a Hot melt glue dispensing system for mattress manufacturing industry. Highly rigid body, easy to handle, programming free, zero maintenance are the key features of the machine.

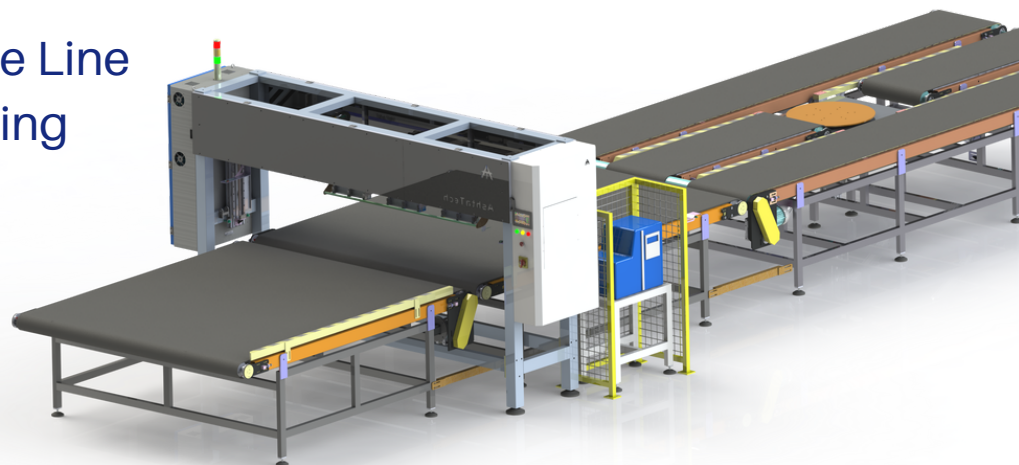

Mattress **Compression** Machine



The Mattress Compression Machine, developed by AshtaTech, represents an advanced and automated solution meticulously designed to cater specifically to the mattress production industry. With its exceptional compression capabilities, precise control mechanisms, and efficient operation, this cutting-edge machine empowers manufacturers to streamline their production processes and maximize space utilization. By leveraging the technology of the Mattress Compression Machine, manufacturers can achieve enhanced operational efficiency, superior product quality, and a competitive edge in the market.

Quality Inspection **Conveyor**

The Quality Inspection Conveyor by AsthaTech is a state-of-the-art solution designed to ensure meticulous quality control in industries such as food manufacturing, mattress production, and automobile manufacturing. It provides a reliable and efficient platform for thorough inspection of products, helping businesses maintain high quality standards and minimize defects.



Cross & Straight Roller **Conveyor**



The Cross & Straight Roller Conveyors by AshtaTech are a versatile and efficient solution for precise and controlled material handling in industries such as food manufacturing, mattress production, and automobile manufacturing. It utilizes a unique design to ensure smooth and accurate movement of goods along the production line.

Automatic **Mattress** **Production** Line

The Automatic Mattress Production Line is an advanced and comprehensive solution designed for efficient and precise mattress manufacturing. It integrates cutting-edge technology and automation to streamline the production process, ensuring high-quality mattresses with increased productivity.

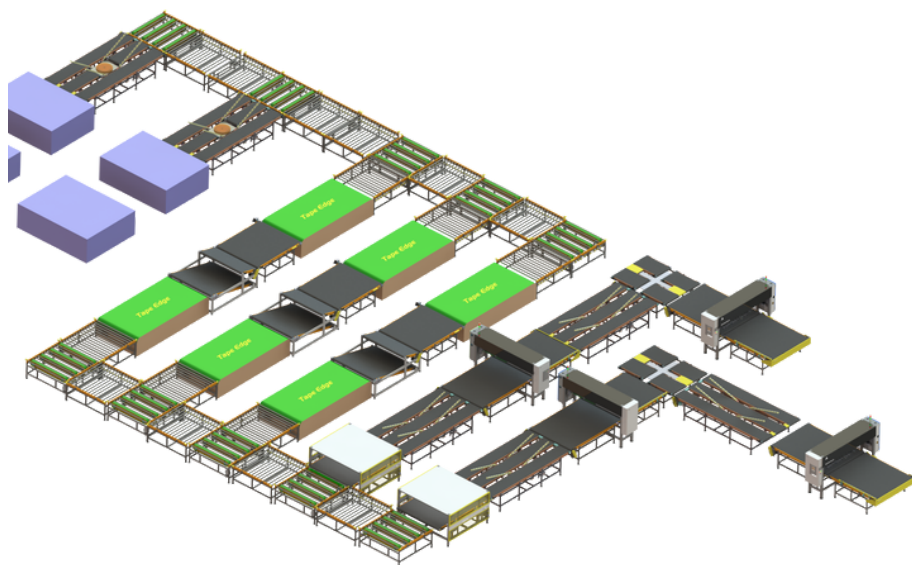

Explosive & Defence Industry

Explo Track & Trace Packing Line

Ashtatech has successfully pioneered a track and trace packaging line specifically designed for the explosive industry. This innovative system ensures that each explosive unit is assigned a unique QR code, enabling efficient traceability throughout its lifecycle. In the event of any missing explosives, the system provides an easy and effective means of tracing their whereabouts. This robust solution serves as a formidable deterrent against theft and unauthorized use of explosives, bolstering safety and security measures within the industry. The track and trace packaging line by Ashtatech represents a significant advancement in the management and control of explosives, offering unparalleled levels of accountability and mitigating potential risks associated with their misuse.

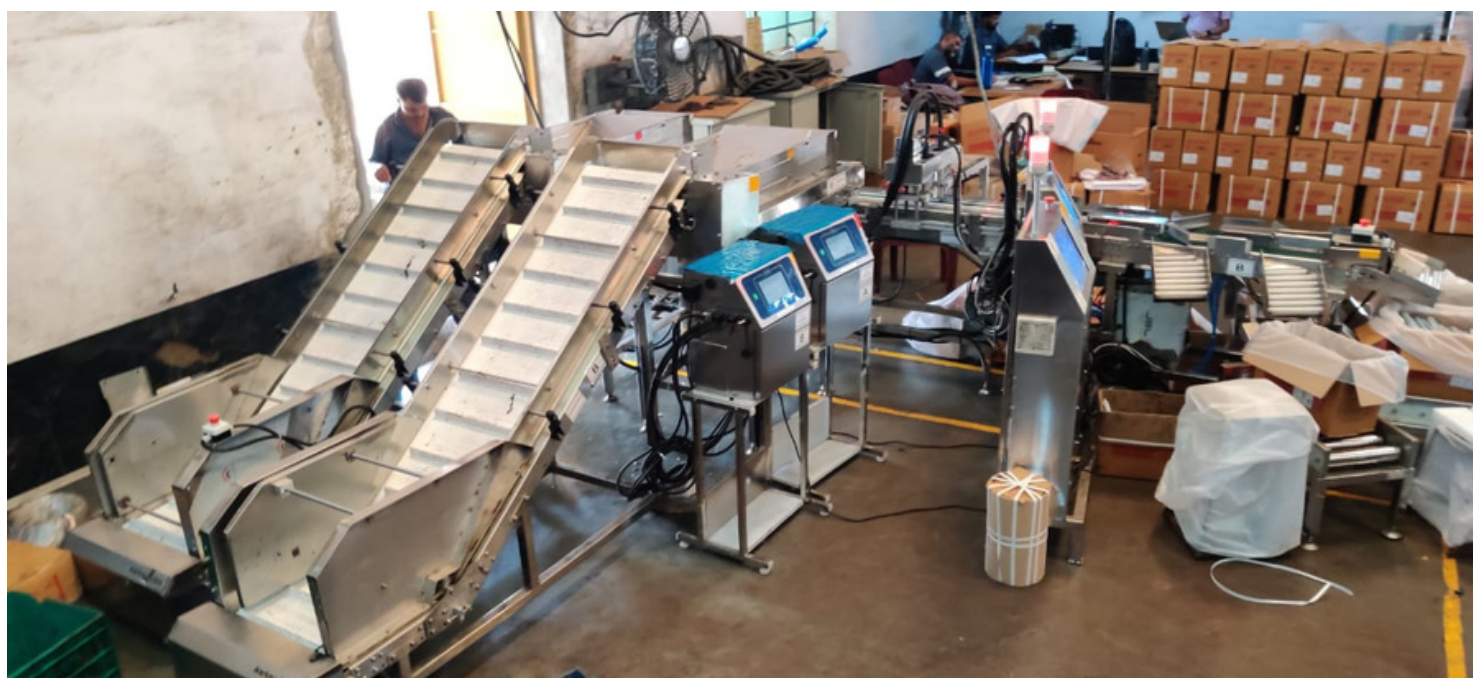

Electronics Industry

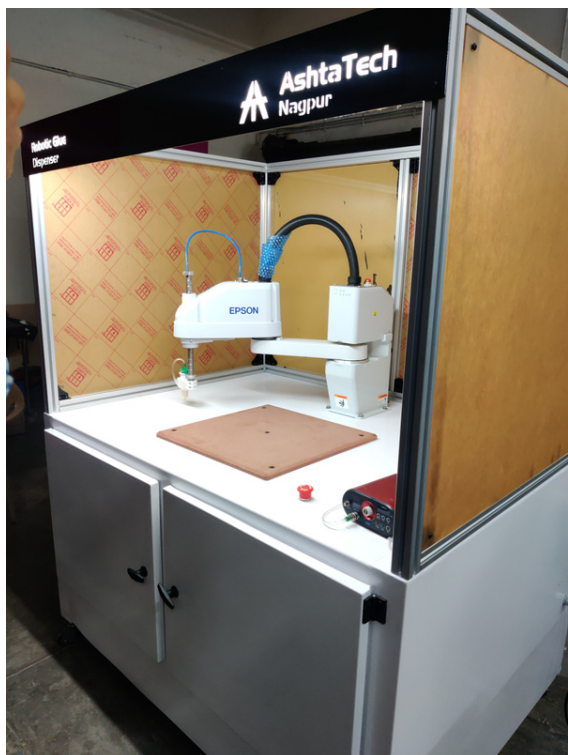

Glue Dispensing Automation



Switch Testing Automation

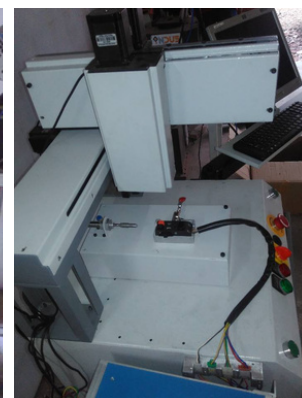

Mobile Screen Testing Automation



Steam Iron Gluing & Pressing Automation

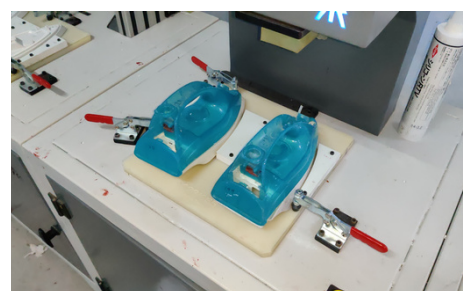

Automobile Industry

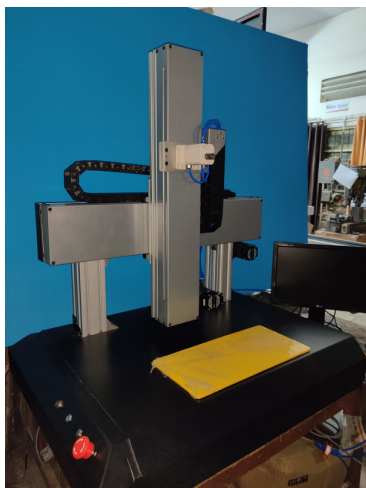

Car Screen Testing Automation



Car Sun Roof Glue Dispensing Automation



4 Axis ATC CNC Machine



Tractor Axle Hub Testing Automation

Miscellaneous Projects

Cooling Tunnel Automation

Differential Hub Chamferring Machine

Oil Hole Drilling Machine

CN C PCB ATC Drilling Machine

Metal & PCB Itching Machine

Paneer Cutting Machine

Fan Guard Welding Machine

Pipe Drilling Tapping Machine

Marine Tank Circular Welding Machine

PCB Shearing Machine

Auto Embossing & Stamping Machine

& many more.....

Our Valuable Clients



Ashta Tech Automation Pvt Ltd.

Plot No-C/18/4, M.I.D.C., Hingna Ind.
area, Nagpur, Maharashtra, 440028

+91 9970410170 / +91 9923491961

info@ashtatech.com

www.ashtatech.com